

vtech[®]

Parent's Guide

Tool Box Friends



INTRODUCTION

Meet the popping Tool Box Friends by **VTech**®. This bright and colourful tool box is a great toy to support your little ones imaginative play. The 3 adorable individual characters can be taken in and out of the tool box and will encourage role-play. Use the friendly tools to press, roll or turn the nail, screw or wood block to support and develop fine motor skills and hand eye coordination.

Hammer

Screwdriver

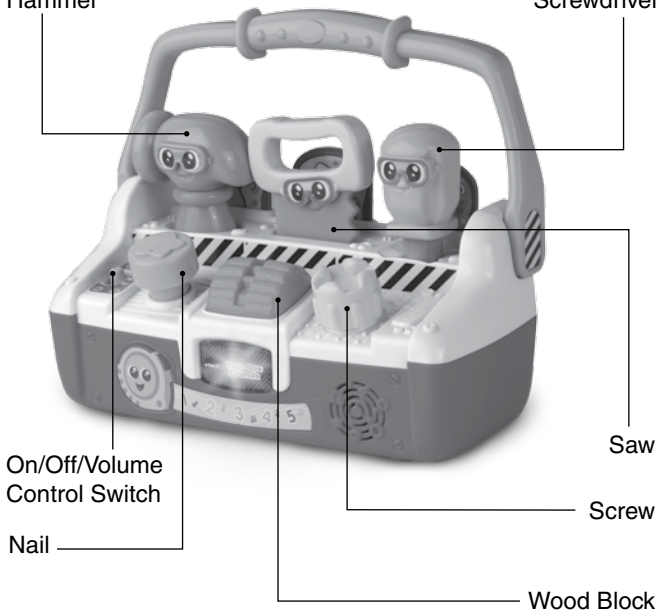

INCLUDED IN THIS PACKAGE

- One Tool Box Friends
- One Hammer
- One Screwdriver
- One Saw
- One Parent's Guide

WARNING: All packing materials such as tape, plastic sheets, packaging locks, removable tags, cable ties and packaging screws are not part of this toy and should be discarded for your child's safety.

NOTE: Please keep this Parent's Guide as it contains important information.

Unlock the packaging locks:

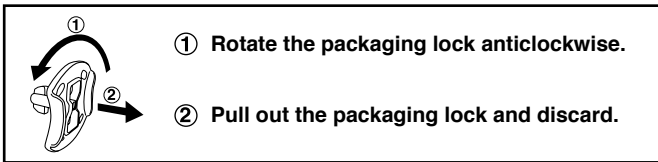

GETTING STARTED

BATTERY INSTALLATION

1. Make sure the unit is turned **OFF**.
2. Locate the battery cover on the bottom of the toolbox. Use a screwdriver to loosen the screw.
3. Install 2 new AA (AM-3/LR6) batteries following the diagram inside the battery box. (The use of new alkaline batteries is recommended for maximum performance.)
4. Replace the battery cover and tighten the screw to secure.

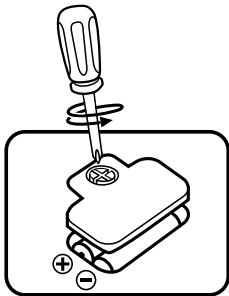

BATTERY NOTICE

- Use new alkaline batteries or fully charged NI-MH (Nickel Metal-hydride) rechargeable batteries for best performance.
- Use only batteries of the same or equivalent type as recommended.
- Do not mix different types of batteries: alkaline, standard (carbon-zinc) or rechargeable, or new and used batteries.
- Do not use damaged batteries.
- Insert batteries with the correct polarity.
- Do not short-circuit the battery terminals.
- Remove exhausted batteries from the toy.
- Remove batteries during long periods of non-use.
- Do not dispose of batteries in fire.
- Do not charge non-rechargeable batteries.
- Remove rechargeable batteries from the toy before charging (if removable).
- Rechargeable batteries are only to be charged under adult supervision.

Disposal of batteries and product



The crossed-out wheellie bin symbols on products and batteries, or on their respective packaging, indicates they must not be disposed of in domestic waste as they contain substances that can be damaging to the environment and human health.



The chemical symbols Hg, Cd or Pb, where marked, indicate that the battery contains more than the specified value of mercury (Hg), cadmium (Cd) or lead (Pb) set out in Battery Directive (2006/66/EC).

The solid bar indicates that the product was placed on the market after 13th August, 2005.

Help protect the environment by disposing of your product or batteries responsibly.

For more information, please visit:

www.recycle-more.co.uk

www.recyclenow.com

PRODUCT FEATURES

1. On/Off/Volume Control Switch

To turn the unit **On**, slide the **On/Off/Volume Control Switch** to the **Low Volume** (🔊) or **High Volume** (🔊) position. You will hear a song, phrase and fun sound. To turn the unit **Off**, slide the **On/Off/Volume Control Switch** to the **Off** (●) position.

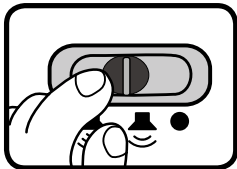

2. Automatic Shut Off

To preserve battery life, the **Tool Box Friends** will automatically power down after approximately 90 seconds without input. The unit can be turned on again by pressing any button.

NOTE: If the unit powers down while playing, we suggest changing the batteries.

The cord is not part of this toy. For your child's safety, please cut and discard the cord before using the product.



ACTIVITIES

1. Hammer and Nail

Use the **Hammer** to tap the **Nail** and learn about colours, numbers, counting and hear a variety of playful sounds and melodies. You will also hear playful phrases inviting you to find other tools. The light will flash with the sounds.



2. Saw and Wood Block

Use the **Saw** to saw the **Wood Block** and learn about colours, opposites and hear a variety of playful sounds and melodies. You will also hear playful phrases inviting you to find other tools. The light will flash with the sounds.



3. Screwdriver and Screw

Use the **Screwdriver** to turn the **Screw** and learn about colours and hear a variety of playful sounds and melodies. You will also hear playful phrases inviting you to find other tools. The light will flash with the sounds.

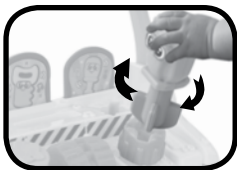

4. Tool Slots

Insert or remove the tools from the **Tool Slots** to hear the tools identify themselves. You will also hear construction sounds, melodies, and the tools singing songs about themselves. The light will flash with the sounds.



SONG LIST

Song 1

Tap and count, 1-2-3.
Slide the saw back and forth.
Turn the screw round and round.
We'll get the job done quickly.

Song 2

I'm a powerful hammer, I hammer in nails,
Bang, bang, bang, my work is done.

Song 3

I'm a hand saw, I have sharp teeth,
Move me back and forth to cut the wood.

Song 4

I'm a screwdriver, I turn the screws,
Twist me, turn me, round and round.

MELODY LIST

1. Bingo
2. Alouette
3. Georgie Porgie
4. If you're Happy and You Know It
5. I've Been Working on the Railroad
6. Mary Had a Little Lamb
7. One Man Went to Mow
8. She'll Be Comin' Round the Mountain
9. Skip to My Lou
10. Ta-ra-ra Boom-de-ay
11. Yankee Doodle
12. Chopsticks
13. The Bear Went Over the Mountain
14. Hickory, Dickory, Dock
15. Blow the Man Down

CARE & MAINTENANCE

1. Keep the unit clean by wiping it with a slightly damp cloth.
2. Keep the unit out of direct sunlight and away from any direct heat sources.
3. Remove the batteries when the unit is not in use for an extended period of time.
4. Do not drop the unit on a hard surface and do not expose the unit to excess moisture.

TROUBLESHOOTING

If for some reason the program/activity stops working, please follow these steps:

1. Turn the unit **OFF**.
2. Interrupt the power supply by removing the batteries.
3. Let the unit stand for a few minutes, then replace the batteries.
4. Turn the unit back **ON**. The unit will now be ready to play with again.
5. If the product still does not work, install a brand new set of batteries.

If the problem persists, please contact our Consumer Services Department and a service representative will be happy to help you.

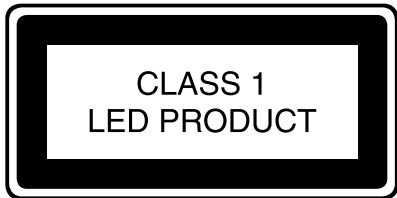

CONSUMER SERVICES

Creating and developing **VTech®** products is accompanied by a responsibility that we at **VTech®** take very seriously. We make every effort to ensure the accuracy of the information, which forms the value of our products. However, errors sometimes can occur. It is important for you to know that we stand behind our products and encourage you to call our Consumer Services Department with any problems and/or suggestions that you might have. A service representative will be happy to help you.

UK Customers:

Phone: 0330 678 0149 (from UK) or +44 330 678 0149 (outside UK)

Website: www.vtech.co.uk/support

Australian Customers:

Phone: 1800 862 155

Website: support.vtech.com.au

NZ Customers:

Phone: 0800 400 785

Website: support.vtech.com.au

PRODUCT WARRANTY/ CONSUMER GUARANTEES

UK Customers:

Read our complete warranty policy online at vtech.co.uk/warranty.

Australian Customers:

**VTECH ELECTRONICS (AUSTRALIA) PTY LIMITED –
CONSUMER GUARANTEES**

Under the Australian Consumer Law, a number of consumer guarantees apply to goods and services supplied by VTech Electronics (Australia) Pty Limited. Please refer to vtech.com.au/consumerguarantees for further information.

**Visit our website for more
information about our products,
downloads, resources and more.**

www.vtech.co.uk
www.vtech.com.au

