

vtech[®]

Parent's Guide

Wiggle & Jiggle Fishing Fun



91-003855-001-000 

VTech understands that a child's needs and abilities change as they grow and with that in mind we develop our toys to teach and entertain at just the right level...

Electronic Learning Computers

Cool, aspirational and inspiring computers for curriculum related learning

vtech Baby

Toys that will stimulate their interest in different textures, sounds and colours

I am...

...responding to colours, sounds and textures

...understanding cause and effect

...learning to touch, reach, grasp, sit-up, crawl and toddle

Birth-36 months



Pre-School

Interactive toys to develop their imagination and encourage language development

I want...

...to get ready for school by starting to learn the alphabet and counting

...my learning to be as fun, easy and exciting as can be

...to show my creativity with drawing and music so my whole brain develops

3-6 years



4-10 years



To learn more about this and other VTech® products, visit www.vtech.co.uk

INTRODUCTION

Thank you for purchasing the **Wiggle & Jiggle Fishing Fun!**
Cast your line into an ocean of seven silly sea creatures. Using the magnetic bobber, pick them up one by one and watch them wiggle! Hear animal facts, colours, numbers and more.

Mode
Selector

Music
Button

Off/Low/
High Volume
Selector

Spinner

Magnetic
Bobber

Play mat

7 Sea
Creatures

Storage
Bucket

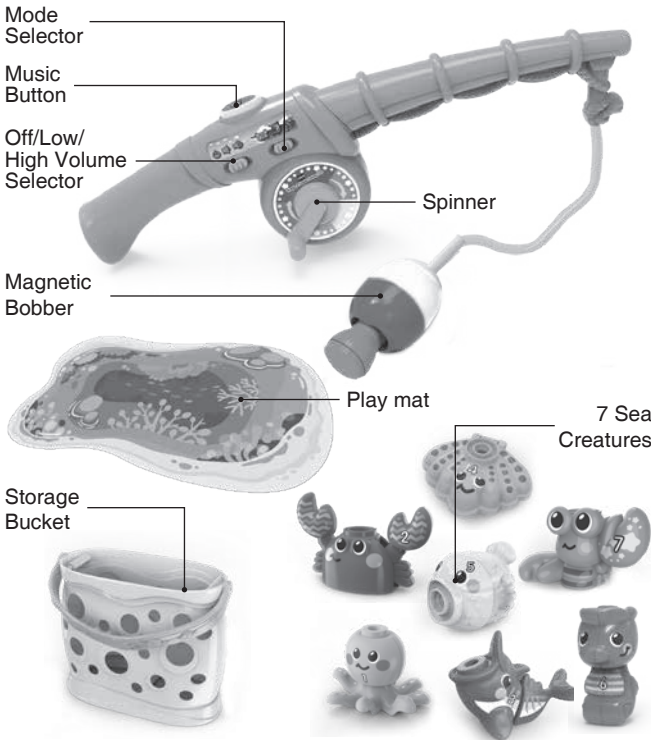

INCLUDED IN THIS PACKAGE

- **Wiggle & Jiggle Fishing Fun**
- 1 Storage Bucket
- 7 Sea Creatures
- 1 Play Mat
- Parent's Guide

NOTE:

This toy is not intended for water play.

WARNING:

All packing materials such as tape, plastic sheets, packaging locks, removable tags, cable ties, paper cord and packaging screws are not part of this toy and should be discarded for your child's safety.

NOTE: Please keep this parent's guide as it contains important information.

Removing the Packaging Locks:

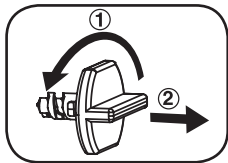

- ① Rotate the packaging lock 90 degrees anticlockwise.
- ② Pull out the packaging lock and discard.

GETTING STARTED

Battery Removal and Installation

1. Make sure the unit is turned **Off**.
2. Find the battery cover located on the bottom of the unit and use a screwdriver to loosen the screw and open the battery cover.
3. Remove old batteries by pulling up on one end of each battery.
4. Install 2 new AA (AM-3/LR6) batteries following the diagram inside the battery box.
5. Replace the battery cover and tighten the screw to secure.

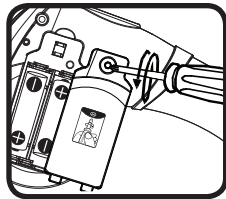

BATTERY NOTICE

- Use only batteries of the same or equivalent type as recommended.
- Do not mix different types of batteries: alkaline, standard (carbon-zinc) or rechargeable, or new and used batteries.
- Do not use damaged batteries.
- Insert batteries with the correct polarity.
- Do not short-circuit the battery terminals.
- Remove exhausted batteries from the toy.
- Remove batteries during long periods of non-use.
- Do not dispose of batteries in fire.
- Do not charge non-rechargeable batteries.
- Remove rechargeable batteries from the toy before charging (if removable).
- Rechargeable batteries are only to be charged under adult supervision.

Disposal of batteries and product



The crossed-out wheellie bin symbols on products and batteries, or on their respective packaging, indicates they must not be disposed of in domestic waste as they contain substances that can be damaging to the environment and human health.



The chemical symbols Hg, Cd or Pb, where marked, indicate that the battery contains more than the specified value of mercury (Hg), cadmium (Cd) or lead (Pb) set out in Battery Directive (2006/66/EC).

The solid bar indicates that the product was placed on the market after 13th August, 2005.

Help protect the environment by disposing of your product or batteries responsibly.

For more information, please visit:

www.recycle-more.co.uk

www.recyclenow.com

PRODUCT FEATURES

1. Off/Low/High Volume Selector

To turn the unit **On** slide the **Off/Low/High Volume Selector** to the High or Low volume setting. Slide the **Off/Low/High Volume Selector** to the **Off** position to turn the **Off**.

2. Mode Selector

Slide the **Mode Selector** to enter Fishing mode, Game mode or Music mode.

3. Music Button

Press the **Music Button** to change the background music.

4. Automatic Shut-Off

To preserve battery life, the **Wiggle & Jiggle Fishing Fun** will automatically shut off after approximately 60 seconds without input. The unit can be turned on again by sliding the **Off/Low/High Volume Selector** to **Low** or **High** volume, or by sliding the **Mode Selector**.

NOTE

This product is in Try Me mode in the packaging. After opening the package, turn the **Wiggle & Jiggle Fishing Fun** off and on again to proceed with normal play. Please straighten the fishing line before initiating play. Remove the crab from the bobber and replace it with the clam, seahorse or octopus. You will hear a beep, confirming that normal play mode has been activated. If the unit repeatedly powers down while playing, please install a new set of batteries.

ACTIVITIES

1. Go Fish

Move the **Mode Selector** to Fishing mode. Connect the **Magnetic Bobber** to a **Sea Creature** to go fishing. Watch the animal wiggle and jiggle and play fun sounds when it's on the **Bobber**. The **Sea Creatures** share animal facts and talk about colours and numbers.



2. Sea Creatures Game

Move the **Mode Selector** to Game mode. The fishing rod will ask a series of questions. Answer three correctly to level up.



3. Songs Under the Sea

Move the **Mode Selector** to Music mode.
Use the **Magnetic Bobber** to catch a **Sea Creature** to hear a song. Press the **Music Button** to change the background music.



SING-ALONG SONG LYRICS

Song 1

Jiggle, giggle, wiggle, (spoken) whoa!
Wiggle, (spoken) whoa!
Jiggle, giggle, wiggle, (spoken) whoa!
Wigg-ly whopp-ers!

Song 2

A-fishing we will go
A-fishing we will go
Heigh ho, catch and release,
A-fishing we will go.

Song 3

To ocean, to ocean is where we all play
Swim around, swim around, hip-hip hooray.
To ocean, to ocean is where we all play
Swim around, swim around, hip-hip hooray!

Song 4

My body has eight arms, so many
Eight arms help me swim in the sea.
I'm the best high-fiver there is!
My eight arms are very handy!

Song 5

I'm a crabby crabby crab-crab.
Crabby-crabby-crab-crab,
Crabby-crabby-crab-crab-crab,
I have two pincers,
Pincer-pincer,
Pincer-pincer-pinch-pinch-pinch.

Song 6

Oh, you are so lucky,
Oh, you are so lucky,
Oh, you are so lucky,
As I'm quite the catch!
Strong, big and fast,
I think I'm pretty great,
Oh, you are so lucky,
I came to eat your bait!

Song 7

Happy as a clam,
I love to be
Smiling and laughing
Make me so happy.

Song 8

I'm a pufferfish,
I'm a pufferfish
Pufferfish like to blow
Up like a balloon
Up like a balloon
Pufferfish like to blow.

Song 9

Home, home in the sea
Where the fish and the animals play.
Where seldom is heard a discouraging word
And my friends and I laugh all day.

Song 10

A lobster, a lobster
A pretty cool lobster.
When I want to move fast
My tail helps me zoom backwards
Backwards, backwards.
My tail helps me zoom backwards
Then I use all my legs
To help me move forward.

CARE & MAINTENANCE

1. Keep the unit clean by wiping it with a slightly damp cloth.
2. Keep the unit out of direct sunlight and away from any direct heat sources.
3. Remove the batteries if the unit will not be in use for an extended period of time.
4. Do not drop the unit on hard surfaces and do not expose the unit to moisture or water.
5. Never try to dismantle the unit.

TROUBLESHOOTING

If for some reason the unit stops working or malfunctions, please follow these steps:

1. Turn the unit **Off**.
2. Interrupt the power supply by removing the batteries.
3. Let the unit stand for a few minutes, then replace the batteries.
4. Turn the unit **On**. The unit should now be ready to use again.
5. If the unit still does not work, install a new set of batteries.



CONSUMER SERVICES

Creating and developing **VTech®** products is accompanied by a responsibility that we at **VTech®** take very seriously. We make every effort to ensure the accuracy of the information, which forms the value of our products. However, errors sometimes can occur. It is important for you to know that we stand behind our products and encourage you to call our Consumer Services Department with any problems and/or suggestions that you might have. A service representative will be happy to help you.

UK Customers:

Phone: 0330 678 0149 (from UK) or +44 330 678 0149 (outside UK)

Website: www.vtech.co.uk/support

Australian Customers:

Phone: 1800 862 155

Website: support.vtech.com.au

NZ Customers:

Phone: 0800 400 785

Website: support.vtech.com.au

PRODUCT WARRANTY/ CONSUMER GUARANTEES

UK Customers:

Read our complete warranty policy online at vtech.co.uk/warranty.

Australian Customers:

VTECH ELECTRONICS (AUSTRALIA) PTY LIMITED –
CONSUMER GUARANTEES

Under the Australian Consumer Law, a number of consumer guarantees apply to goods and services supplied by VTech Electronics (Australia) Pty Limited. Please refer to vtech.com.au/consumerguarantees for further information.

**Visit our website for more
information about our products,
downloads, resources and more.**

www.vtech.co.uk
www.vtech.com.au

