

vtech®

User's Manual

Playtime Bus™ with Phonics



© 2014 VTech
Printed in China
91-009647-005 UK

VTech understands that a child's needs and abilities change as they grow and with that in mind we develop our toys to teach and entertain at just the right level...

vtech Baby

Toys that will stimulate their interest in different textures, sounds and colours

I am...

...responding to colours, sounds and textures

...understanding cause and effect

...learning to touch, reach, grasp, sit-up, crawl and toddle

Birth-36months



Pre-School

Interactive toys to develop their imagination and encourage language development

I want...

...to get ready for school by starting to learn the alphabet and counting

...my learning to be as fun, easy and exciting as can be

...to show my creativity with drawing and music so my whole brain develops

3-6years



Electronic Learning Computers

Cool, aspirational and inspiring computers for curriculum related learning

I need...

...challenging activities that can keep pace with my growing mind

...intelligent technology that adapts to my level of learning

...National Curriculum based content to support what I'm learning at school

4-10years



To learn more about this and other VTech® products, visit www.vtechuk.com

INTRODUCTION

Thank you for purchasing the **VTech® Playtime Bus™ with Phonics!** Start the engine and take a trip with the **VTech® Playtime Bus™ with Phonics!** Through interactive play, your child can learn phonic sounds, letters, vocabulary, numbers, counting and safety rules. The bus also features lots of melodies, sing-along songs and fun, realistic bus sound effects! Learning has never been so much fun!

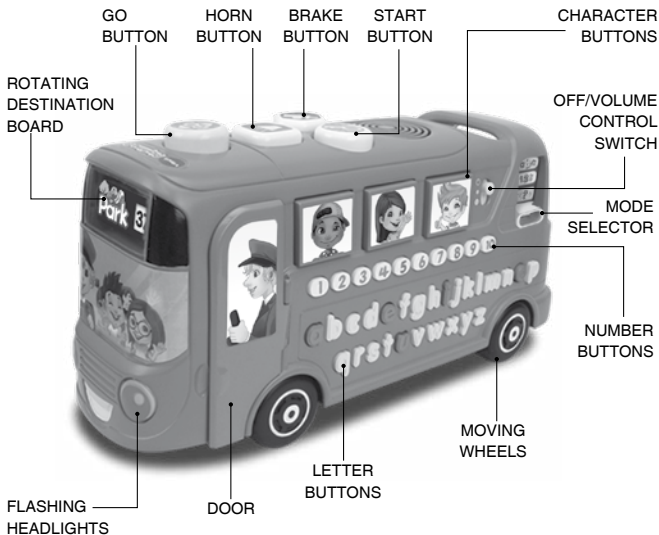

INCLUDED IN THIS PACKAGE

- One VTech® Playtime Bus™ with Phonics
- One instruction manual

WARNING:

All packing materials, such as tape, plastic sheets, packaging locks and tags are not part of this toy, and should be discarded for your child's safety.

NOTE: Please keep instruction manual as it contains important information.

Unlock the packaging locks:

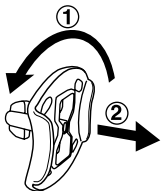

- ① Rotate the packaging lock counter-clockwise 90 degrees.
- ② Pull out the packaging lock.

Demo strip removal:

When the product is taken out of the packaging, please remove the demo strip next to the battery cover to activate the normal play mode.

GETTING STARTED

BATTERY INSTALLATION

1. Make sure the unit is **OFF**.
2. Locate the battery cover on the bottom of the unit.
3. Use a screwdriver or coin to open the cover.
4. Install 2 new “AA” batteries following the diagram inside the battery box. (The use of new, alkaline batteries is recommended for maximum performance.)
5. Replace the battery cover and tighten to secure.

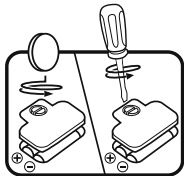

BATTERY NOTICE

- Use new alkaline batteries for maximum performance.
- Use only batteries of the same or equivalent type as recommended.
- Do not mix different types of batteries: alkaline, standard (carbon-zinc) or rechargeable (Ni-Cd, Ni-MH), or new and used batteries.
- Do not use damaged batteries.
- Insert batteries with the correct polarity.
- Do not short-circuit the battery terminals.
- Remove exhausted batteries from the toy.
- Remove batteries during long periods of non-use.
- Do not dispose of batteries in fire.
- Do not charge non-rechargeable batteries.
- Remove rechargeable batteries from the toy before charging (if removable).
- Rechargeable batteries are only to be charged under adult supervision.

Disposal of batteries and product



The crossed-out wheellie bin symbols on products and batteries, or on their respective packaging, indicates they must not be disposed of in domestic waste as they contain substances that can be damaging to the environment and human health.



The chemical symbols Hg, Cd or Pb, where marked, indicate that the battery contains more than the specified value of mercury (Hg), cadmium (Cd) or lead (Pb) set out in Battery Directive (2006/66/EC).

The solid bar indicates that the product was placed on the market after 13th August, 2005.

Help protect the environment by disposing of your product or batteries responsibly.

For more information, please visit:

www.recycle-more.co.uk

www.recyclenow.com

PRODUCT FEATURES

1. OFF/VOLUME CONTROL SWITCH

Slide the **OFF/VOLUME CONTROL SWITCH** to the **HIGH Volume** or the **LOW Volume** position to turn the unit on or adjust the volume.

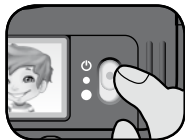

2. MODE SELECTOR

Slide the **MODE SELECTOR** to choose a game to play.



3. CHARACTER BUTTONS

Press a **CHARACTER BUTTON** to learn safety rules or fun phrases.



4. NUMBER BUTTONS

Press the **NUMBER BUTTONS** to learn numbers, answer the questions in the Challenge Time activity or compose music in the Music Station activity.



5. LETTER BUTTONS

Press the **LETTER BUTTONS** to learn phonic sounds, letter names, vocabulary, hear fun sounds or answer the questions in the Challenge Time activity.



6. DOOR

Open the **DOOR** to count how many children get on or off the bus, or shut the **DOOR** to continue your trip.



7. GO BUTTON

Press the **GO BUTTON** to hear the fun sing-along song and see where you will go on the **ROTATING DESTINATION BOARD**.

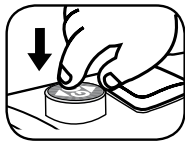

8. HORN BUTTON

Press the **HORN BUTTON** to hear the bus horn.



9. START BUTTON

Press the **START BUTTON** to hear the bus engine sound.

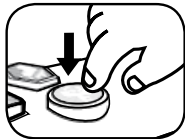

10. BRAKE BUTTON

Press the **BRAKE BUTTON** to hear the bus brake.

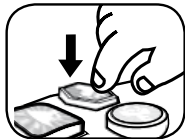

11. MOVING WHEELS

Push the bus for rolling fun and musical play.



12. FLASHING HEADLIGHTS

The **FLASHING HEADLIGHTS** flash when a voice or melody is played.



13. AUTOMATIC SHUT-OFF

To preserve battery life, the **VTech® Playtime Bus™ with Phonics** will automatically power-down after several minutes without input or after around 20 minutes of continuous pushing of the bus. The unit can be reactivated by pressing any button or sliding the Mode Selector.

ACTIVITIES

1. Phonics Explore

Press any **LETTER BUTTON** to learn the phonic sound, letter name, fun vocabulary and to hear some fun sounds.



2. Number Fun

Time to learn our numbers! Press any **NUMBER BUTTON** to learn that number and number order.



3. Challenge Time

Questions about letters and numbers will be asked to reinforce the learning.



4. Music Station

Press a **LETTER BUTTON** to hear different melodies, or press a **NUMBER BUTTON** to hear a music note or to create your own song.



Sing-Along Song Lyrics

1. Ride, ride, ride the bus
Happily to school
There's ABCs and 123s
Learning is so cool!
2. Ride, ride, ride the bus
To the park we ride
We'll run and jump and climb so high
And then go down the slide!
3. Ride, ride, ride the bus
Happily to the zoo
See lions, zebras, birds and apes
And an owl that just says "Who?!"

CARE & MAINTENANCE

1. Keep the unit clean by wiping it with a slightly damp cloth.
2. Keep the unit out of direct sunlight and away from any direct heat source.
3. Remove the batteries when the unit is not in use for an extended period of time.
4. Do not drop the unit on hard surfaces and do not expose the unit to moisture or water.

TROUBLESHOOTING

If for some reason the program/activity stops working or malfunctions, please:

1. Turn the unit OFF.
2. Interrupt the power supply by removing the batteries.
3. Let the unit stand for a few minutes, then replace the batteries.
4. Turn the unit ON. The unit should now be ready to play again.
5. If the product still does not work, replace with a new set of batteries.

If the problem persists, please call our Consumer Services Department on 01235 546810 (from UK) or +44 1235 546810 (outside UK) and a service representative will be happy to help you.

IMPORTANT NOTE:

Creating and developing **VTech®** products is accompanied by a responsibility that we at **VTech®** take very seriously. We make every effort to ensure the accuracy of the information that forms the value of our products. However, errors sometimes can occur. It is important for you to know that we stand behind our products and encourage you to call our Consumer Services Department on 01235 546810 (from UK), or +44 1235 546810 (outside UK) with any problems and/or suggestions that you might have. A service representative will be happy to help you.





PRODUCT WARRANTY



Thank you for choosing this quality product from VTech. We hope it will bring many hours of entertainment, imaginative play and learning.

1. The product detailed above is covered by a one year warranty from the date of purchase, against any defects in materials or workmanship.
2. The product may be returned to the place of purchase. Alternatively the product can be returned to VTech Electronics Europe plc (see address below), with proof of purchase, without proof of purchase no replacement will be provided.
3. VTech Electronics Europe plc will examine the product and if it is found to be defective due to faulty materials or workmanship, will replace the product at their discretion.
4. If the product covered by this warranty is damaged due to misuse, modification or unauthorised repair, or because of faulty batteries, battery discharge or incorrect electrical connections, then this warranty becomes void.
5. This warranty is personal to the original purchaser and is not transferable.
6. Breakages to the LCD screen are not covered by the warranty.
7. Returns to VTech Electronics Europe plc should include a cheque or postal order for £1.50 towards the cost of return postage and packaging.
8. Products returned to VTech Electronics Europe plc, should be addressed as follows and packed carefully to avoid damage in transit (Please do not include batteries or adaptor).
Please include details of the fault together with your name and address.

VTech Electronics Europe plc, c/o Tablogix Limited, 200 Milton Park, Abingdon, Oxon OX14 4TA

THIS WARRANTY IS OFFERED AS AN EXTRA BENEFIT AND DOES NOT AFFECT CONSUMERS' STATUTORY RIGHTS.

This warranty is valid for the UK and Eire only. For products purchased outside the UK and Eire, please contact your local distributor or place of purchase.

