

WELCOME TO KINGDOM BUILDERS™!

Kingdom Builders™ takes place in the magical land of Buildera, where you have the power to build anything you want.

MEET THE BUILDERS!

THE BUILDERS SEEK TO CREATE A BETTER KINGDOM FOR THE SUBJECTS OF BUILDERA. THE BUILDERS TRANSFORM INTO POWERFUL BUILDING TOOLS!



Sir Philip™

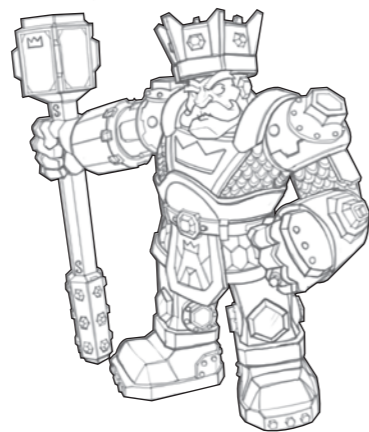

King Hex™



Lady Twist™

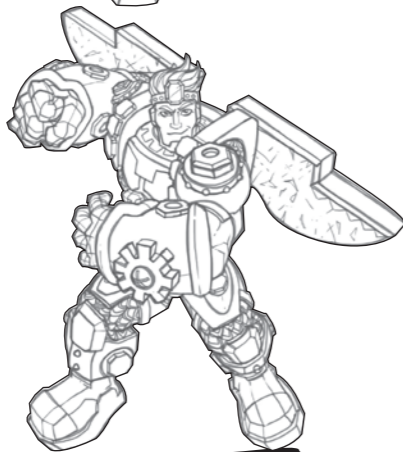

Sir Wrench-A-Lot™

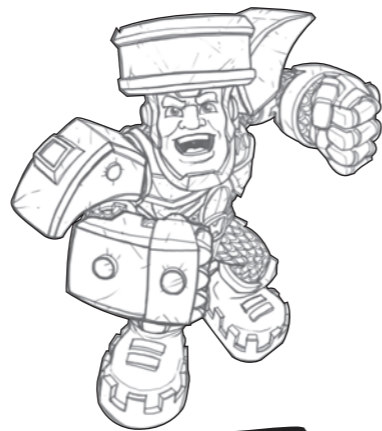

Sir Hammer of Head™

COLLECT THEM ALL!

Each Sold Separately

MEET THE BASHERS!

THE BASHERS WANT TO BE BETTER BUILDERS BUT THEIR MISCHIEVOUS NATURE GETS IN THE WAY. THE BASHERS TRANSFORM INTO DEMOLISHING TOOLS!

Captain Cannonblast™



Crow DeBar™



Sledge Hammerfist™

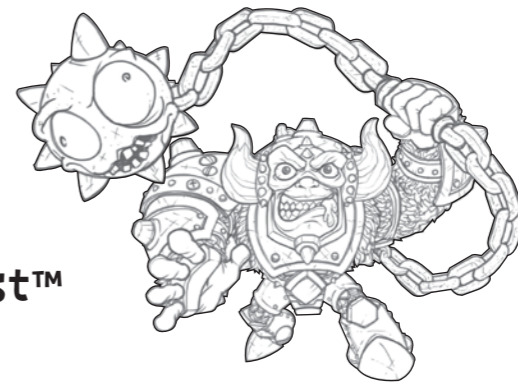

Wreckin', The Ball-Bariah™

BUILD YOUR KINGDOM!

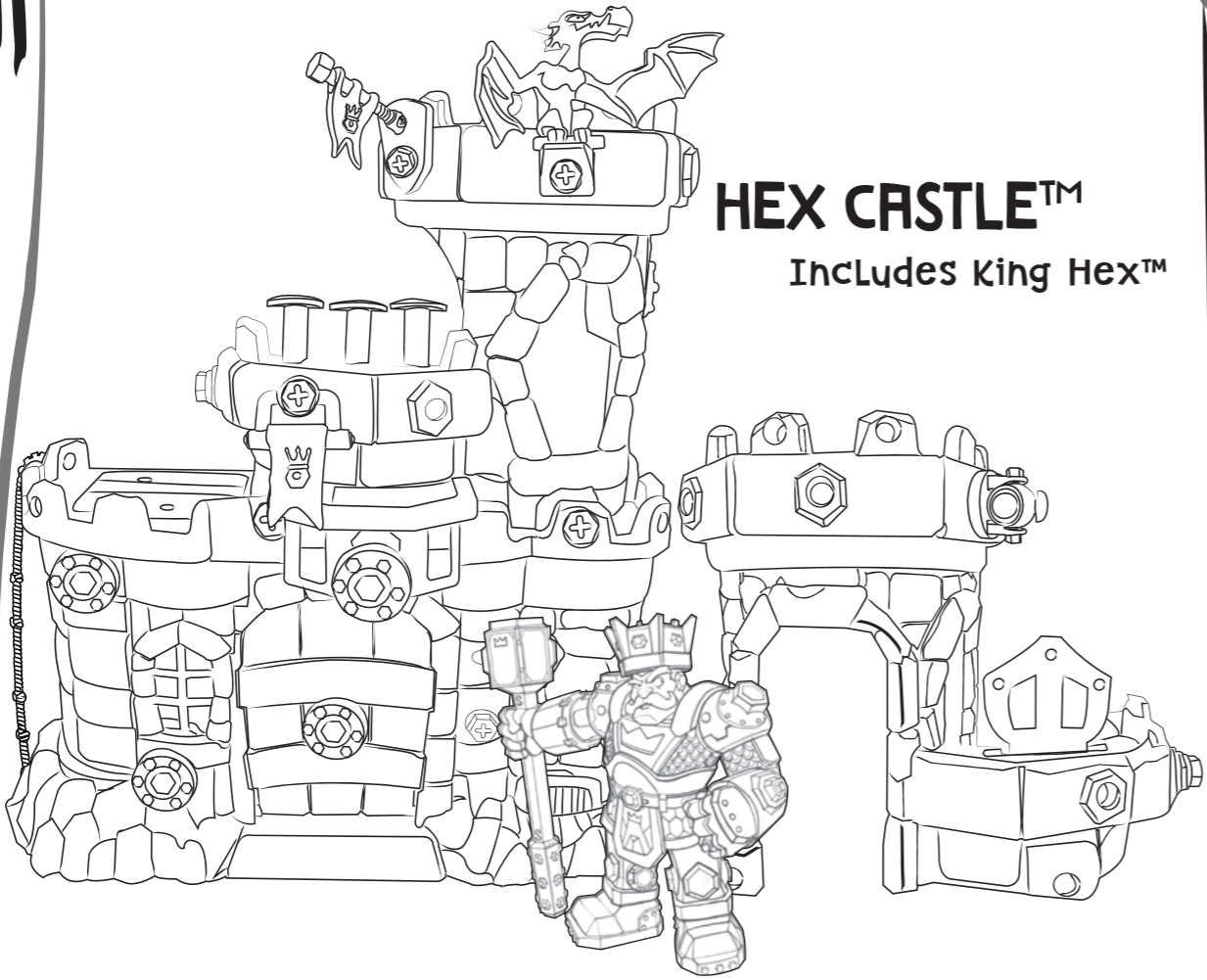

HEX CASTLE™
Includes King Hex™

BUILD A BEAST™

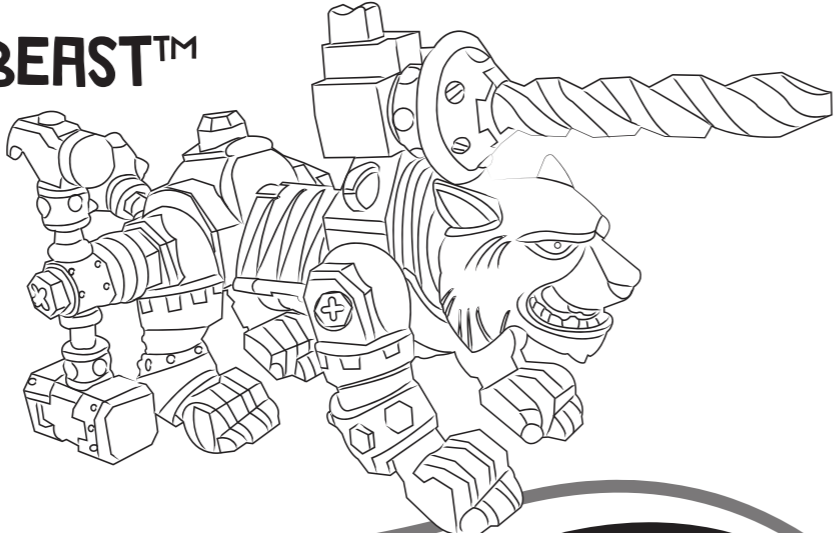

Each Sold Separately



WRECKIN' ROLLER™
Includes Captain Cannonblast™

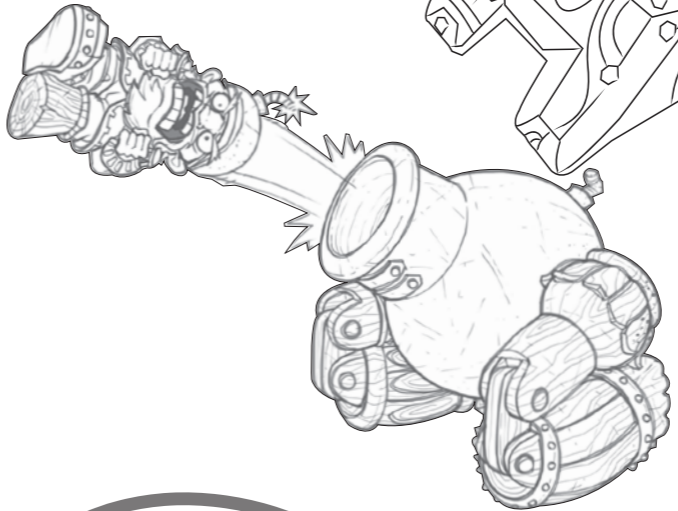



WARNING:
 CHOKING HAZARD-Toy contains a small ball & small parts.
 Not for children under 3 years.

HEX CASTLE™

SKU: 647116

Ages 3+

WATCH US ON: **YouTube**

VISIT US AT: LittleTikes.com/KingdomBuilders

IMPORTANT INFORMATION

- Do not stand on, sit on, or throw the castle pieces into furniture, walls, pets, people, etc., as doing so may cause injury to the person and irreparable damage to the units.
- Avoid placing the castle on an uneven surface or anywhere which might offer the possibility of tipping.
- Do not launch cannon ball or cross bow at people, pets, or their eyes.
- Keep the included accessories away from eyes and face.
- The accessories are not actual tools. This item is a toy and is intended for play purposes only.
- There are multiple ways to build your castle.
- The bolts on the accessories come attached.

LIMITED WARRANTY

The Little Tikes Company makes fun, high quality toys. We warrant to the original purchaser that this product is free of defects in materials or workmanship for one year * from the date of purchase (dated sales receipt is required for proof of purchase). At the sole election of The Little Tikes Company, the only remedies available under this warranty will be the replacement of the defective part or replacement of the product. This warranty is valid only if the product has been assembled and maintained per the instructions. This warranty does not cover abuse, accident, cosmetic issues such as fading or scratches from normal wear, or any other cause not arising from defects in material and workmanship. *The warranty period is three (3) months for daycare or commercial purchasers. U.S.A and Canada: For warranty service or replacement part information, please visit our website at www.littletikes.com, call 1-800-321-0183 or write to: Consumer Service, The Little Tikes Company, 2180 Barlow Road, Hudson OH 44236, U.S.A. Some replacement parts may be available for purchase after warranty expires—contact us for details. Outside U.S.A and Canada: Contact place of purchase for warranty service. This warranty gives you specific legal rights, and you may also have other rights, which vary from country/state to country/state. Some countries/states do not allow the exclusion or limitation of incidental or consequential damages, so the above limitation or exclusion may not apply to you.

Please keep this manual as it contains important information.



0518-0-E/INT

© 2018 The Little Tikes Company
 an MGA Entertainment company.
 LITTLE TIKES® and KINGDOM BUILDERS™ are trademarks of
 Little Tikes in the U.S. and other countries. All logos, names,
 characters, likenesses, images, slogans, and packaging
 appearance are the property of Little Tikes.
 Little Tikes Consumer Service
 2180 Barlow Road Hudson, Ohio 44236 U.S.A.
 1-800-321-0183
 Printed in China

MGA Entertainment UK Ltd
 50 Presley Way
 Crownhill
 Milton Keynes
 MK8 0ES
 Bucks, UK
 0800 521 558

www.littletikes.com
www.littletikes.co.uk



Visit our website at
www.littletikes.com
 to register your product and
 to enter our sweepstakes.
 (No purchase necessary)

CONTENTS

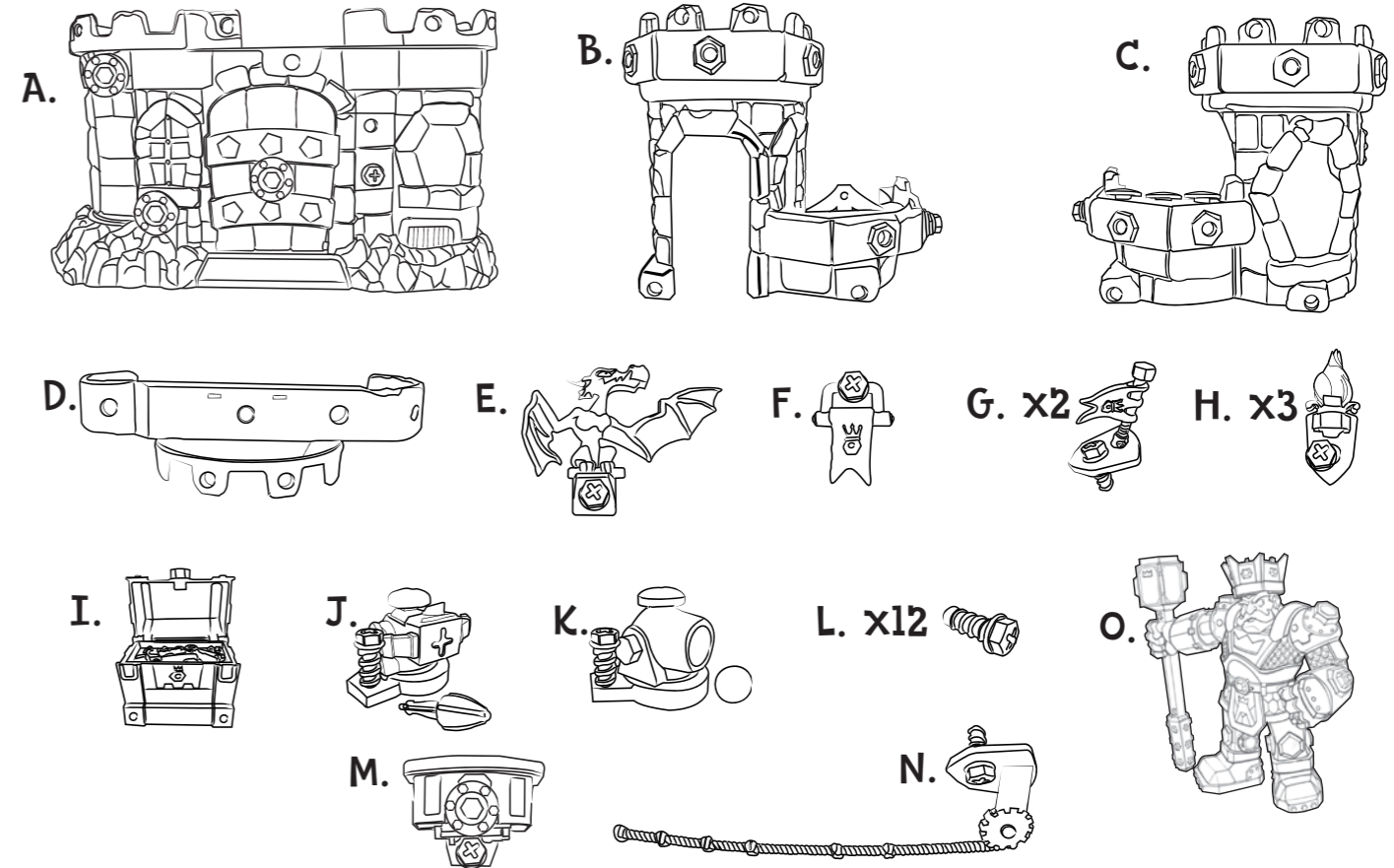

Illustrations are for reference only. Styles may vary from actual contents.

ASSEMBLY

Some minor assembly might be needed before you begin building your castle.

Assemble tower piece (B) by attaching the shield piece to the tower.

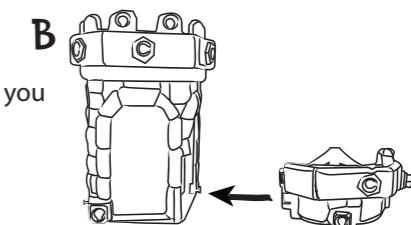

KING HEX'S TRANSFORMATION

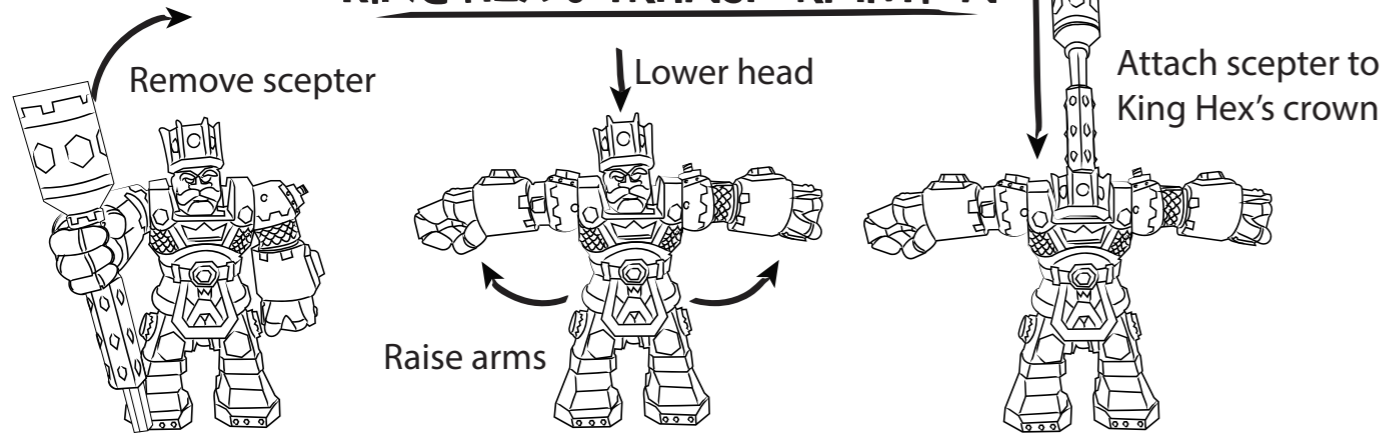

BUILDING HEX CASTLE™

There are multiple ways to build your castle. Below is just one way to build it.

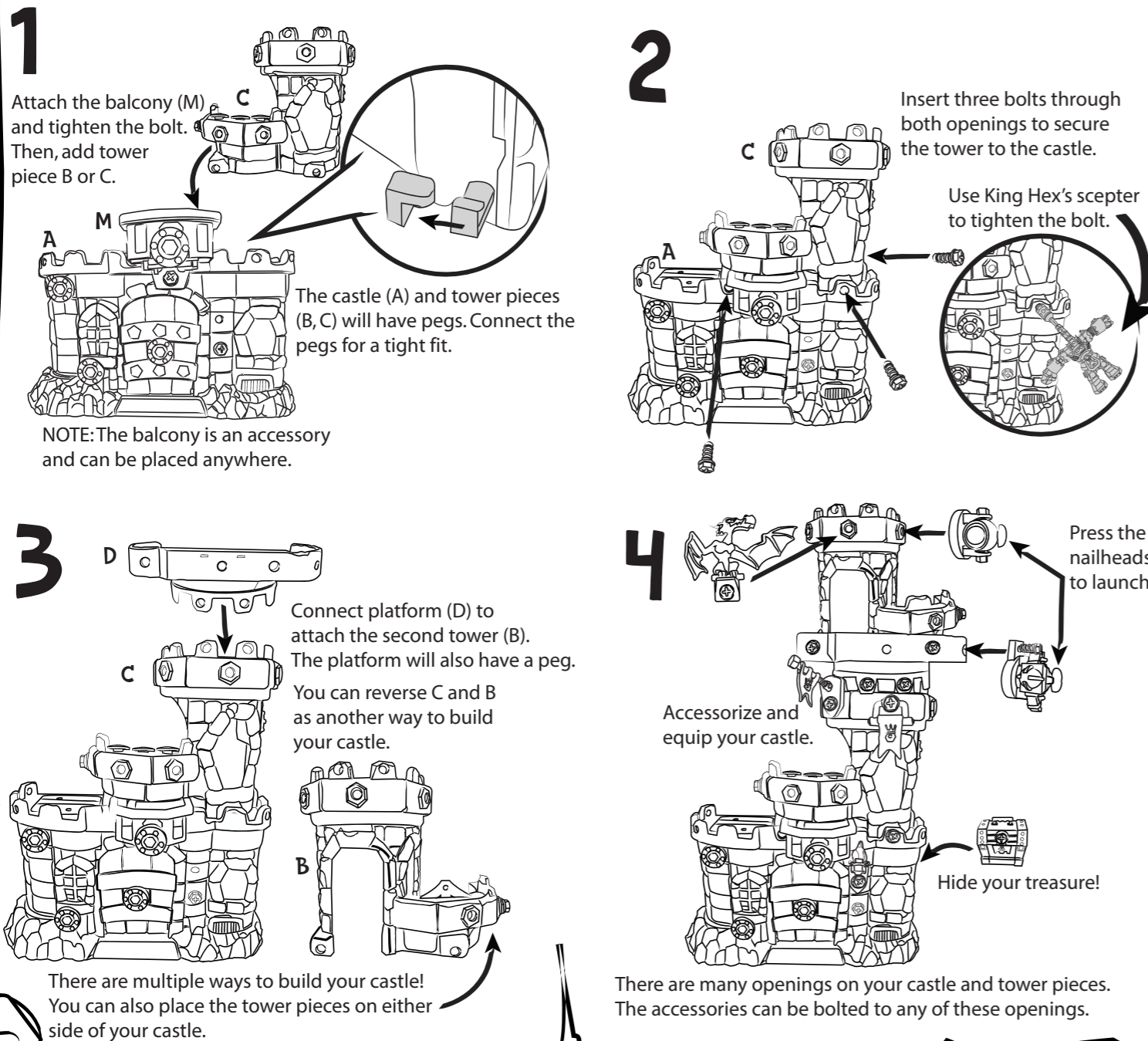

PROTECTING HEX CASTLE™

When the Bashers (not included) come to attack, know your castle's hidden secrets.

