

vtech®

Parent's Guide

My!a⁺ The Magical⁺
Unicorn⁺™



91-003530-005 US

INTRODUCTION

Thank you for purchasing **Myla The Magical Unicorn™**! Hi! I'm Myla, welcome to my world of music and magic! Using my magic brush, select any color and apply it to my eyes, wings and horn to create unique styles! We can also play games, sing and have lots of fun together!

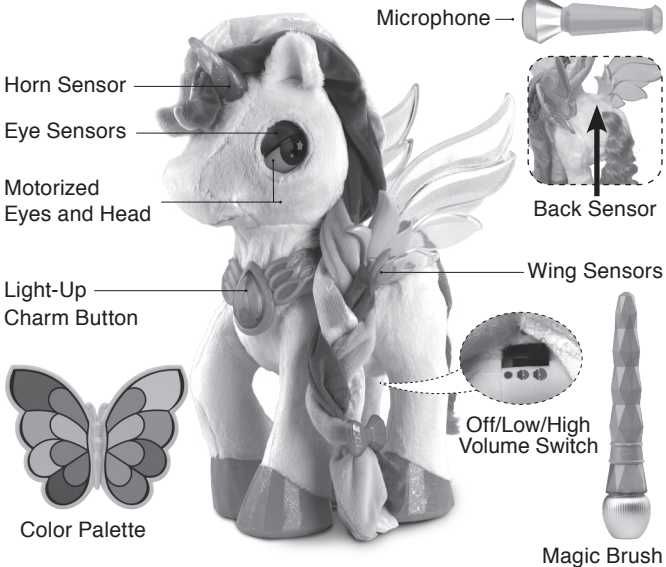

Bundled Accessories: Comb & Hair Clips

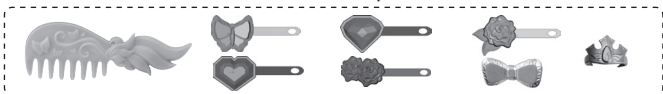

INCLUDED IN THIS PACKAGE

- One **Myla The Magical Unicorn™**
- One magic brush
- One color palette
- One microphone
- One comb
- Five hair clips
- One crown
- One parent's guide

WARNING:

All packing materials such as tape, plastic sheets, packaging locks, removable tags, cable ties and packaging screws are not part of this toy, and should be discarded for your child's safety.

NOTE: Please keep this parent's guide as it contains important information.

ATTENTION :

Pour la sécurité de votre enfant, débarrassez-vous de tous les produits d'emballage tels que rubans adhésifs, feuilles de plastique, attaches, étiquettes et vis d'emballage. Ils ne font pas partie du jouet.

NOTE : Il est conseillé de conserver ce guide des parents car il comporte des informations importantes.



WARNING:

**CHOKING HAZARD - small parts
Not for children under 3 years.**



ATTENTION :

**DANGER D'ÉTOUFFEMENT - Petits éléments.
Ne convient pas aux enfants de moins de 3 ans.**

Unlock the packaging locks:

- ① Rotate the packaging locks 90 degrees counterclockwise.
- ② Pull out the packaging locks.

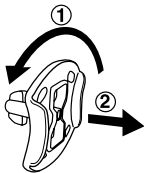

GETTING STARTED

How to Exit Try-Me Mode

Myla is in try-me mode in the packaging.

Slide the **Off/Low/High Volume Switch** to the **Off** position to turn the unit **Off**. Then, turn the unit **On** again to exit try-me mode.

Alternatively, putting the microphone close to Myla's mouth to enter the Sing with Me game, will exit try-me mode.

Myla Quick Start

Try any of these actions to play with Myla.

- 1) Press Myla's **Light-Up Charm Button** to switch between five different games:
 - Magical Makeup
 - Magical Color Creation
 - Lucky Color
 - Amazing Makeup Powder
 - Showtime!
- 2) Pat Myla's back to hear sweet phrases and see light patterns.
- 3) Use the **Magic Brush** and the **Color Palette** to decorate Myla's eyes, horn, and wings (Myla starts in Magical Makeup mode when you first turn her on).
- 4) Place the **Microphone** by Myla's mouth to get her to start singing. Remove the **Microphone** and Myla's music continues, but her singing stops so you can belt out a solo!

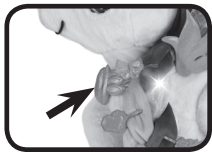

Battery Installation (Unicorn)

1. Make sure the unit is turned **OFF**.
2. Locate the battery cover on the underside of the unit.
3. Install 4 new AA size (LR6/AM-3) batteries following the diagram inside the battery box. (The use of new alkaline batteries is recommended for maximum performance).
4. Replace the battery cover to secure it.

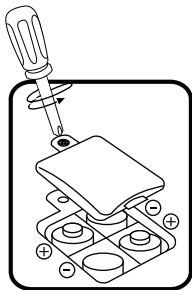

Battery Installation (Brush)

1. Make sure the unit is turned **OFF**.
2. Locate the battery cover of the unit.
3. Install 2 new AAA size (LR03/AM-4) batteries following the diagram inside the battery box. (The use of new alkaline batteries is recommended for maximum performance).
4. Replace the battery cover to secure it.

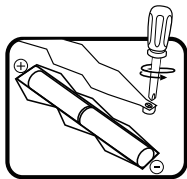

BATTERY NOTICE

- Use new alkaline batteries for maximum performance.
- Use only batteries of the same or equivalent type as recommended.
- Do not mix different types of batteries: alkaline, standard (carbon-zinc) or rechargeable, or new and used batteries.
- Do not use damaged batteries.
- Insert batteries with the correct polarity.
- Do not short-circuit the battery terminals.
- Remove exhausted batteries from the toy.
- Remove batteries during long periods of non-use.
- Do not dispose of batteries in fire.
- Do not charge non-rechargeable batteries.
- Remove rechargeable batteries from the toy before charging (if removable).

- Rechargeable batteries are only to be charged under adult supervision.

PRODUCT FEATURES

1. Off/Low/High Volume Switch

Slide the **Off/Low/High Volume Switch** to either **Low** or **High** to turn the unit **On**. To turn the unit **Off**, slide the switch to **Off**.



2. Horn, Eye and Wing Sensors

Use the **Magic Brush** to choose a color from the **Color Palette** and point to the appropriate sensor to see Myla's eyes, wings or horn and mane light up.



Horn Sensor



Eye Sensors



Wing Sensors

3. Light-Up Charm Button

Press Myla's **Light-Up Charm Button** to choose different play modes.

4. Magic Brush and Color Palette

Use the **Magic Brush** to choose a color from the **Color Palette** and point to Myla's horn, eyes or wings to play.

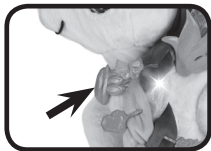

In order to recognize the color successfully, make sure the transparent part of the **Magic Brush** is pressed down and is completely in the selected color on the **Color Palette**. Keep pressing until the brush lights up with the color you have selected.

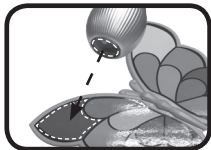

If the **Color Palette** gets dirty, please wipe it with a soft, dry cloth, otherwise the colors may not be recognized successfully. To get the best recognition, we suggest playing indoors.

5. **Microphone**

Put the **Microphone** close to Myla's mouth to hear her sing. While she is singing, if you pull the **Microphone** away, she will stop singing but keep playing music so you can sing on your own.



6. **Motorized Eyes and Head**

Myla's eyes will blink and her head will move as she talks.



7. **Back Sensor**

Touch Myla's back to hear sweet phrases and see light patterns.

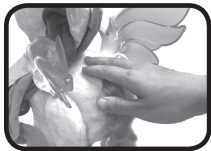

8. **Automatic Shut Off**

To preserve battery life, the unit will automatically shut off after several minutes without input. Myla can be restarted by pressing the **Light-Up Charm Button**; the **Magic Brush** will light up again by pressing on the **Color Palette** to choose a color.

When the unit repeatedly powers down, please insert new batteries and try switching it on again.

ACTIVITIES

1. **Magical Makeup**

Let's decorate Myla! Use the **Magic Brush** to choose a color on the **Color Palette** and put it on Myla's horn, eyes or wings.

2. **Magical Color Creation**

Let's create magical colors! Use the **Magic Brush** to choose a

color on the **Color Palette** and put it on Myla's horn, eyes or wings. Then, use the **Magic Brush** to choose another color and put it on the same horn, eye or wing.

3. Lucky Color

Touch Myla's back, she will tell you your lucky color!

4. Amazing Make-Up Powder

Use the **Magic Brush** to choose a color on the **Color Palette** and apply to the spot that flashes. Keep applying her makeup to the different flashing points before time runs out!

5. Showtime!

Press Myla's **Light-Up Charm Button** to hear her sing. When she's singing, put your hand on her **Back Sensor** to add some light effects to her horn, mane, eyes and wings.

6. Sing with Me

Put the **Microphone** close to Myla's mouth and sing with her. Remove the **Microphone** to keep the music going while you belt out a solo.

SONGS

So Many Colors

Red and green and yellow too,
Purple is a mix of red and blue.
So many colors in this world
That I can share with you!

Shine On, Inspire the World

We're going to shine on, inspire the world
With light and love for all the boys and girls.
Won't you brighten your day with Myla the Unicorn!

We Can Do Anything!

Brush my tail.
Do my hair.

Find a color for my eyes and wings.

The two of us

Will be best friends.

We can do anything!

If You Can Dream It

If you can dream it, then you can be it.

There's nothing that you can't do.

If you believe it, then you can see it.

Let's all celebrate with you!

Let's Go!

Won't You Sing Along?

I love to sing won't you sing along.

It's lots of fun to sing. There's magic in a song, yeah!

With our friends we're singing out all day long.

Let's Sing!

CARE & MAINTENANCE

1. Keep the unit clean by wiping it with a slightly damp cloth.
2. Keep the unit out of direct sunlight and away from any direct heat source.
3. Remove the batteries when the unit is not in use for an extended period of time.
4. Do not drop the unit on hard surfaces and do not expose the unit to moisture or water.

TROUBLESHOOTING

If for some reason the unit stops working or malfunctions, please follow these steps:

1. Please turn the unit OFF.
2. Interrupt the power supply by removing the batteries.
3. Let the unit stand for a few minutes, then replace the batteries.
4. Turn the unit ON. The unit should now be ready to play again.
5. If the product still does not work, replace with a new set of batteries.

If the problem persists, please call our Consumer Services Department at 1-800-521-2010 in the U.S. or 1-877-352-8697 in Canada, or by going to our web site at vtechkids.com and filling out our Contact Us form located under the Customer Support link. A service representative will be happy to help you.

IMPORTANT NOTE:

Creating and developing **VTech®** products is accompanied by a responsibility that we at **VTech®** take very seriously. We make every effort to ensure the accuracy of the information, which forms the value of our products. However, errors sometimes can occur. It is important for you to know that we stand behind our products and encourage you to call our Consumer Services Department at 1-800-521-2010 in the U.S. or 1-877-352-8697 in Canada, or by going to our web site at vtechkids.com and filling out our Contact Us form located under the Customer Support link with any problems and/or suggestions that you might have. A service representative will be happy to help you.

Note:

This equipment has been tested and found to comply with the limits for a Class B digital device, pursuant to Part 15 of the FCC Rules. These limits are designed to provide reasonable protection against harmful interference in a residential installation. This equipment generates, uses and can radiate radio frequency energy and, if not installed and used in accordance with the instructions, may cause harmful interference to radio communications. However, there is no guarantee that interference will not occur in a particular installation. If this equipment does cause harmful interference to radio or television reception, which can be determined by turning the equipment off and on, the user is encouraged to try to correct the interference by one or more of the following measures:

- Reorient or relocate the receiving antenna.
- Increase the separation between the equipment and receiver.
- Connect the equipment into an outlet on a circuit different from that to which the receiver is connected.
- Consult the dealer or an experienced radio/TV technician for help.

Supplier's Declaration of Conformity

Trade Name: VTech®
Model: 1825
Product name: Myla The Magical Unicorn™
Responsible Party: VTech Electronics North America, LLC
Address: 1156 W. Shure Drive, Suite 200,
Arlington Heights, IL 60004
Website: vtechkids.com

THIS DEVICE COMPLIES WITH PART 15 OF THE FCC RULES. OPERATION IS SUBJECT TO THE FOLLOWING TWO CONDITIONS: (1) THIS DEVICE MAY NOT CAUSE HARMFUL INTERFERENCE, AND (2) THIS DEVICE MUST ACCEPT ANY INTERFERENCE RECEIVED, INCLUDING INTERFERENCE THAT MAY CAUSE UNDESIRE OPERATION.

Caution: Changes or modifications not expressly approved by the party responsible for compliance could void the user's authority to operate the equipment.

This device contains licence-exempt transmitter(s)/receiver(s) that comply with Innovation, Science and Economic Development Canada's licence-exempt RSS(s). Operation is subject to the following two conditions:

- (1) This device may not cause interference.
- (2) This device must accept any interference, including interference that may cause undesired operation of the device.

L'émetteur/récepteur exempt de licence contenu dans le présent appareil est conforme aux CNR d'Innovation, Sciences et Développement économique Canada applicables aux appareils radio exempts de licence. L'exploitation est autorisée aux deux conditions suivantes :

- 1) L'appareil ne doit pas produire de brouillage;
- 2) L'appareil doit accepter tout brouillage radioélectrique subi, même si le brouillage est susceptible d'en compromettre le fonctionnement.

**Visit our website for more
information about our products,
downloads, resources and more.**

vtechkids.com

Read our complete warranty policy online at
vtechkids.com/warranty



TM & © 2018 VTech Holdings Limited.

All rights reserved.

Printed in China.

91-003530-005 