

vtech[®]
Baby

Parent's Guide

Smart Sounds Baby Keys™

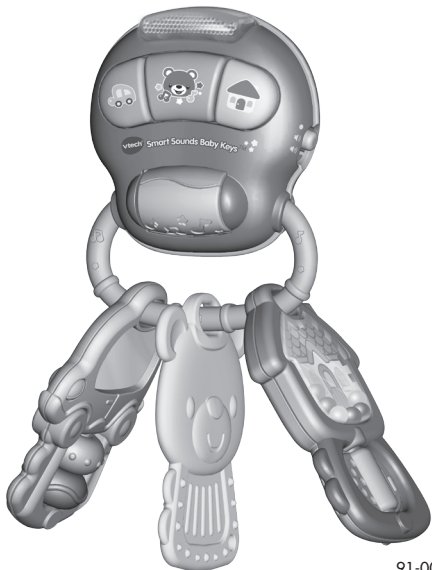

91-003479-000 (US)

INTRODUCTION

Thank you for purchasing the **VTech® Smart Sounds Baby Keys™**. Press the three colorful buttons or shake the keys to hear songs, phrases, music and cute sound effects. Dangling keys have rattle beads, a baby-safe mirror, a teether and rollers for even more fun!

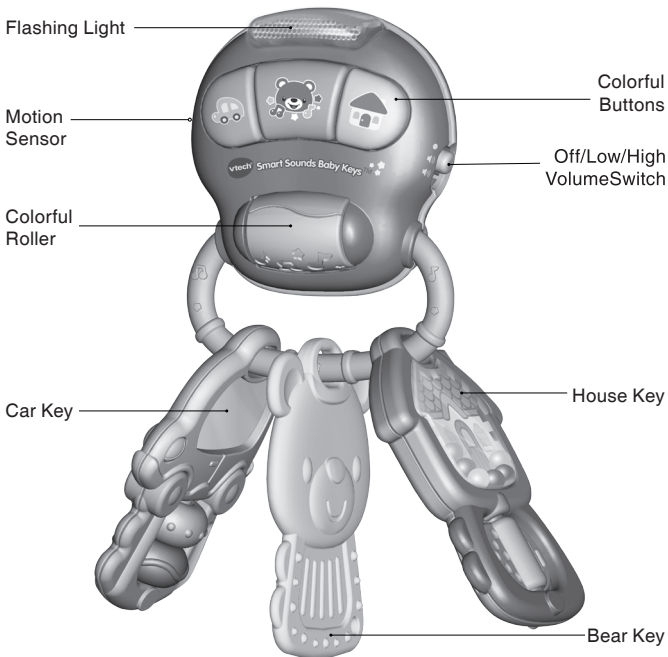

INCLUDED IN THIS PACKAGE

- One Smart Sounds Baby Keys™
- One parent's guide

WARNING: All packing materials such as tape, plastic sheets, packaging locks, removable tags, cable ties and packaging screws are not part of this toy, and should be discarded for your child's safety.

NOTE: Please keep this parent's guide as it contains important information.

ATTENTION : Pour la sécurité de votre enfant, débarrassez-vous de tous les produits d'emballage tels que rubans adhésifs, feuilles de plastique, attaches, étiquettes et vis d'emballage. Ils ne font pas partie du jouet.

NOTE : Il est conseillé de conserver ce guide des parents car il comporte des informations importantes.

Unlock the packaging locks:

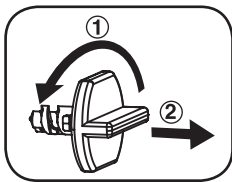

- ① Turn the packaging lock counter-clockwise several times.
- ② Pull out and discard the packaging lock.

GETTING STARTED

BATTERY INSTALLATION

1. Make sure the unit is turned **OFF**.
2. Locate the battery cover on the bottom of the unit.
3. Use a screwdriver to loosen the screw.
4. Install 3 new LR44 button cell batteries following the diagram inside the battery box. (The use of new alkaline batteries is recommended for maximum performance.)
5. Replace the battery cover and tighten the screw to secure.

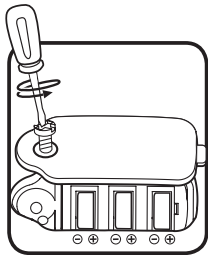



BATTERY NOTICE

- Use three LR44 Alkaline button cell batteries only for this toy.
- The button cell batteries used with this product should be kept away from small children who might still put things in their mouths. If the button cell batteries are swallowed, consult a doctor immediately.
- This product contains button cell batteries. Swallowing a button cell battery can cause internal chemical burns in as little as two hours and can lead to death. If you think batteries might have been swallowed or placed inside any part of the body, seek immediate medical attention.
- Insert the button cell batteries with the correct polarity.
- Do not use damaged button cell batteries.
- Do not short-circuit the button cell battery terminals.
- Remove exhausted button cell batteries from the product.
- Remove button cell batteries during long periods of non-use.
- Do not dispose of button cell batteries in fire.
- Do not charge non-rechargeable button cell batteries.

- Remove rechargeable batteries from the toy before charging.
- Rechargeable batteries are only to be charged under adult supervision.
- Do not mix old and new batteries.
- Do not mix batteries of different types: alkaline, standard (carbonzinc) or rechargeable.

PRODUCT FEATURES

1. Off/Low/High Volume Switch

To turn the unit **ON**, slide the **Off/Low/High Volume Switch** to the **High Volume** () or **Low Volume** () position. You will hear a song and a variety of playful phrases.

To turn the unit **OFF**, slide the **Off/Low/High Volume Switch** to the **Off** () position.



2. Automatic Shut Off

To preserve battery life, the **Smart Sounds Baby Keys™** will automatically power down after approximately 30 seconds without input. The unit can be turned on again by pressing one of the three buttons.

NOTE: If the unit powers down while playing, we suggest changing the batteries.

ACTIVITIES

1. Colorful Buttons

Press each of the three **Colorful Buttons** to hear playful songs, phrases and melodies. Press the car button to hear car sound effects, the bear button to hear cute and playful bear growls, and the home button to hear keys jangling and the sound of a door opening.



When a melody is playing, shake the keys to hear fun sounds play over the melody. When pressing and holding two of the colorful buttons at the same time, additional fun sound responses will be played. The light will flash with the sounds.

2. Motion Sensor

Shake the keys to activate the **Motion Sensor**. You will hear a variety of playful sounds and phrases. The light will flash with the sounds.



3. Colorful Roller

Spin the **Colorful Roller** to hear the beads bouncing around inside the barrel and to encourage development of fine motor skills.



4. House Key

Shake the **House Key** to hear the colorful beads rattle and introduce cause and effect. Spin the blue disc to promote fine motor skills.



5. Car Key

The **Car Key** features a baby-safe mirror that helps develop self-awareness and self-discovery of object permanence. The textured rollers promote sensory development and fine motor skills.



6. Bear Key

The soft **Bear Key** soothes your little one's sore gums and the textured design promotes sensory development.



SONG LYRICS

SONG 1

The sun is out,
The sky is blue.
Grab your keys and take me with you.

SONG 2

The wheels on the car go round and round,
Turn the keys,
Start the car.
The wheels on the car go round and round,
All through the town.

SONG 3

Home sweet home.
Use our key.
Open the door,
To see who's waiting for me.

MELODY LIST

1. Home Sweet Home
2. Pease Porridge Hot
3. Hot Cross Buns
4. The Green Grass Grew All Around
5. Shoo Fly, Don't Bother Me
6. The Teddy Bears' Picnic
7. Twinkle, Twinkle, Little Star
8. The Bear Went Over the Mountain
9. Skip to My Lou
10. Animal Fair
11. She'll be Coming 'Round the Mountain
12. Jack and Jill
13. Take Me Out to the Ball Game
14. Polly Wolly Doodle
15. BINGO

CARE & MAINTENANCE

1. Keep the unit clean by wiping it with a slightly damp cloth.
2. Keep the unit out of direct sunlight and away from any direct heat source.
3. Remove the batteries when the unit will not be in use for an extended period of time.
4. Do not drop the unit on hard surfaces and do not expose the unit to moisture or water.

TROUBLESHOOTING

If for some reason the unit stops working or malfunctions, please follow these steps:

1. Please turn the unit **OFF**.
2. Interrupt the power supply by removing the batteries.
3. Let the unit sit for a few minutes, then replace the batteries.
4. Turn the unit **ON**. The unit should now be ready to play again.
5. If the unit still does not work, replace with an entire set of new batteries.

If the problem persists, please call our Consumer Services Department at 1-800-521-2010 in the U.S. or 1-877-352-8697 in Canada, or by going to our website at vtechkids.com and filling out our Contact Us form located under the Customer Support link. A service representative will be happy to help you.

IMPORTANT NOTE:

Creating and developing **VTech**[®] products is accompanied by a responsibility that we at **VTech**[®] take very seriously. We make every effort to ensure the accuracy of the information, which forms the value of our products. However, errors sometimes can occur. It is important for you to know that we stand behind our products and encourage you to call our Consumer Services Department at 1-800-521-2010 in the U.S. or 1-877-352-8697 in Canada, or by going to our website at vtechkids.com and filling out our Contact Us form located under the Customer Support link with any problems and/or suggestions that you might have. A service representative will be happy to help you.

NOTE:

This equipment has been tested and found to comply with the limits for a Class B digital device, pursuant to Part 15 of the FCC Rules. These limits are designed to provide reasonable protection against harmful interference in a residential installation. This equipment generates, uses and can radiate radio frequency energy and, if not installed and used in accordance with the instructions, may cause harmful interference to radio communications. However, there is no guarantee that interference will not occur in a particular installation. If this equipment does cause harmful interference to radio or television reception, which can be determined by turning the equipment off and on, the user is encouraged to try to correct the interference by one or more of the following measures:

- Reorient or relocate the receiving antenna.
- Increase the separation between the equipment and receiver.
- Connect the equipment into an outlet on a circuit different from that to which the receiver is connected.
- Consult the dealer or an experienced radio/TV technician for help.

THIS DEVICE COMPLIES WITH PART 15 OF THE FCC RULES. OPERATION IS SUBJECT TO THE FOLLOWING TWO CONDITIONS: (1) THIS DEVICE MAY NOT CAUSE HARMFUL INTERFERENCE, AND (2) THIS DEVICE MUST ACCEPT ANY INTERFERENCE RECEIVED, INCLUDING INTERFERENCE THAT MAY CAUSE UNDESIRE OPERATION.

CAN ICES-3 (B)/NMB-3(B)

Caution: Changes or modifications not expressly approved by the party responsible for compliance could void the user's authority to operate the equipment.

**Visit our website for more
information about our products,
downloads, resources and more.**

vtechkids.com

*Read our complete warranty policy online at
vtechkids.com/warranty*

