

vtech®

Parent's Guide

**TURBO**  
**FORCE**  
*RACERS*  
*Race Track*

**VTech understands that a child's needs and abilities change as they grow and with that in mind we develop our toys to teach and entertain at just the right level...**

## **vtech** Baby

**Toys that will stimulate their interest in different textures, sounds and colours**

### **I am...**

...responding to colours, sounds and textures

...understanding cause and effect

...learning to touch, reach, grasp, sit-up, crawl and toddle

*Birth-36 months*



## **Pre-School**

**Interactive toys to develop their imagination and encourage language development**

### **I want...**

...to get ready for school by starting to learn the alphabet and counting

...my learning to be as fun, easy and exciting as can be

...to show my creativity with drawing and music so my whole brain develops

*3-6 years*



## **Electronic Learning Computers**

**Cool, aspirational and inspiring computers for curriculum related learning**

### **I need...**

...challenging activities that can keep pace with my growing mind

...intelligent technology that adapts to my level of learning

...National Curriculum based content to support what I'm learning at school

*4-10 years*



To learn more about this and other VTech® products, visit [www.vtech.co.uk](http://www.vtech.co.uk)

# INTRODUCTION

Thank you for purchasing the **VTech® Turbo Force® Racers Race Track!** Re-configure this cool track set into 4 different combinations; 2 epic racer circuits or 2 cool stunt tracks! The Race Track comes complete with a **Turbo Force® Racer & Turbo Station** wristband. **Turbo Force® Racer** charges whilst docked in the **The Turbo Station**. When racing, shake the wristband to charge your turbo boost!

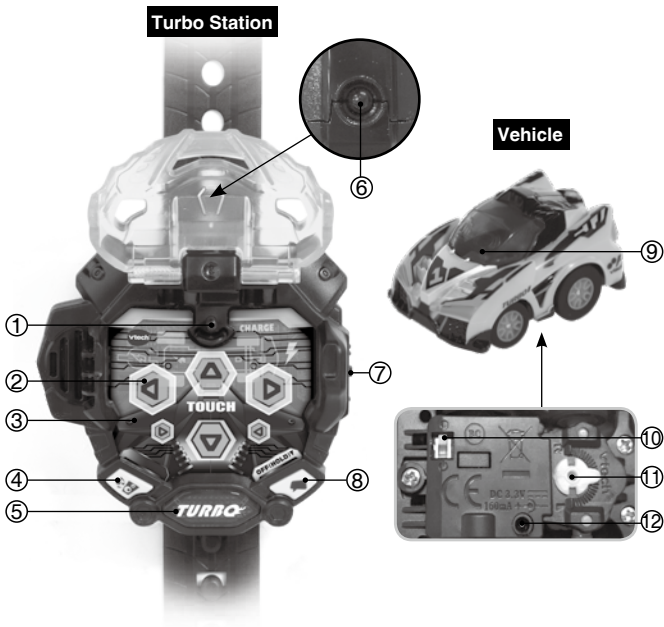



13

- |                       |                        |                    |          |
|-----------------------|------------------------|--------------------|----------|
| ① Charge Pole         | ⑤ Turbo Button         | ⑨ Lights           | ⑬ 4-in-1 |
| ② Directional Buttons | ⑥ IR Controller Sensor | ⑩ ON/OFF Switch    |          |
| ③ Motion Sensor       | ⑦ Channel Switch       | ⑫ Charge Contact   |          |
| ④ Sounds Button       | ⑧ Talk (OFF) Button    | ⑪ Alignment Adjust |          |

## INCLUDED IN THIS PACKAGE



One Turbo Station  
Wristband



One Vehicle



Three Spiral  
Bracket Bases

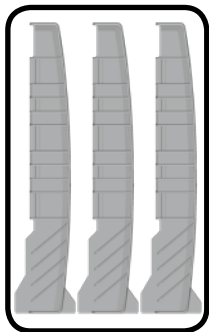

Three Spiral  
Brackets

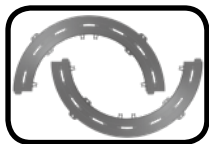

Two Spiral Tracks

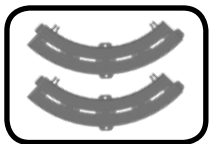

Two Round Tracks  
Single Standard

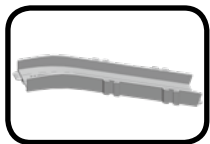

One Transparent  
Track



Two Jump Tracks



Three Tracks  
Straight Standard

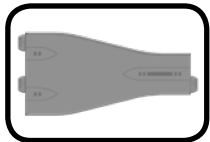

One Track  
Combined Standard

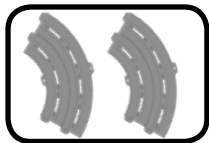

Two Round Tracks  
Double Standard

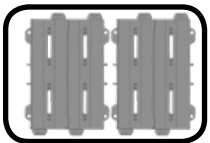

Two Straight Tracks  
Double Standard

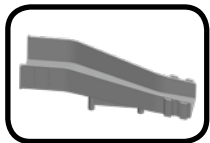

One Jump  
Down Track

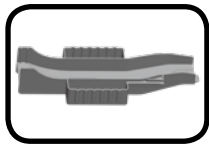

One Jump  
Down Track Base

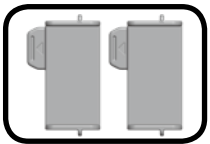

Two Jump Down  
Connector Tracks



One Stunt  
A Track



One Stunt  
B Track

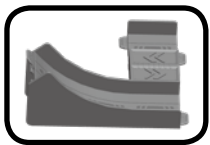

One Stunt  
Connector Track

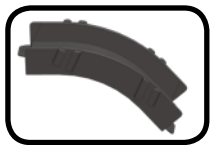

One Spiral Track  
Connector

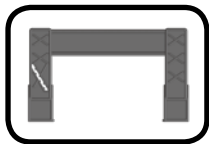

Double Gate



Single Gate

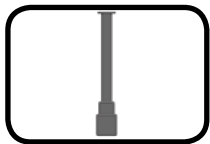

Stunt Track Holder

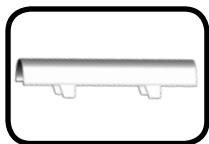

One Transparent  
Cover A

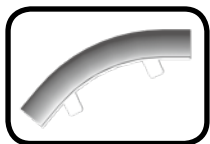

One Transparent  
Cover B



One Transparent  
Cover C

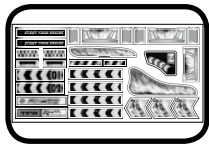

Track Labels



Track Card



Parent's Guide

**WARNING:** All packing materials such as tape, plastic sheets, packaging locks, removable tags, cable ties and packaging screws are not part of this toy and should be discarded for your child's safety.

**NOTE:** Please keep this parent's guide as it contains important information.

**IMPORTANT NOTE:**

1. For optimal performance, please use the vehicle on a flat, smooth surface.
2. For your child's safety, do not put the vehicle in either configuration on your clothing, body or hair.



# GETTING STARTED

## METHOD TO EXIT TRY-ME MODE:

Insert the vehicle into the **Turbo Station Charge Pole** to charge the vehicle and enter travel mode. Alternatively, remove the batteries from the **Turbo Station** and install a brand new set of batteries. Then, turn the **Turbo Station** on again to enter normal play mode.

## TURBO STATION: BATTERY REMOVAL AND INSTALLATION

1. Make sure the **Turbo Station** is turned **OFF**.
2. Locate the battery cover on the bottom of the **Turbo Station**.
3. Use a screwdriver to loosen the screw and open the battery cover.
4. If used or spent batteries are present, remove these batteries from the **Turbo Station** by pulling up on one end of each battery.
5. Install 2 new AAA (LR03/AM-4) batteries into the battery box as illustrated. (The use of new alkaline batteries is recommended for maximum performance).
6. Replace the battery cover and tighten the screw to secure.

**Note:** If there is no response when the **Turbo Station** is on, please insert new batteries and try again.

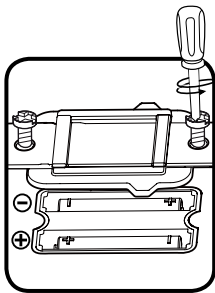



## BATTERY NOTICE

- Alkaline Batteries are recommended. Rechargeable batteries are not guaranteed to work with this product for best performance.
- Use only batteries of the same or equivalent type as recommended.
- Do not mix different types of batteries: alkaline, standard (carbon-zinc) or rechargeable, or new and used batteries.
- Do not use damaged batteries.
- Insert batteries with the correct polarity.
- Do not short-circuit the battery terminals.
- Remove exhausted batteries from the toy.
- Remove batteries during long periods of non-use.
- Do not dispose of batteries in fire.
- Do not charge non-rechargeable batteries.
- Remove rechargeable batteries from the toy before charging (if removable).
- Rechargeable batteries are only to be charged under adult supervision.

## Disposal of batteries and product



The crossed-out wheellie bin symbols on products and batteries, or on their respective packaging, indicates they must not be disposed of in domestic waste as they contain substances that can be damaging to the environment and human health.



The chemical symbols Hg, Cd or Pb, where marked, indicate that the battery contains more than the specified value of mercury (Hg), cadmium (Cd) or lead (Pb) set out in Battery Directive (2006/66/EC).

The solid bar indicates that the product was placed on the market after 13th August, 2005.

Help protect the environment by disposing of your product or batteries responsibly.

For more information, please visit:

[www.recycle-more.co.uk](http://www.recycle-more.co.uk)

[www.recyclenow.com](http://www.recyclenow.com)

## VEHICLE CHARGING:

Insert the vehicle into the **Turbo Station's Charge Pole** to charge the vehicle. The light on the **Turbo Station** will flash during the charging process. When the vehicle is fully charged, the light on the **Turbo Station** will stay turned on for a short time.



### Note:

1. The battery inside the vehicle is not replaceable.
2. Turning the vehicle off will allow the vehicle to charge faster.
3. The battery in this product must not be disposed of with household waste. This battery is recyclable, please follow your local recycling regulations.
4. If the vehicle does not connect and function normally with the **Turbo Station**, or the lights on the vehicle do not light up, please insert the vehicle into the **Turbo Station's Charge Pole** to charge it.
5. Please check the **Charge Pole** regularly and stop usage if it is damaged.

## PLAYING WITH MULTIPLE TURBO FORCE® RACERS

When playing with 2 or more **Turbo Force® Racers** vehicles you may experience channel clashing when controlling your vehicle. To avoid any clashes, slide the **Channel Switch** on your **Turbo Station** so it is different to any other **Turbo Station** wristbands nearby.



### **Remark:**

1. The orange, green and blue **Turbo Stations** share the same 2 channels, 3 of them can't play together but 2 of them can.
2. If you have followed the above advice and are still experiencing channel clashing, please ensure the Channel Switches are set correctly. Then, turn all **Turbo Stations** and vehicles off. After that, one player at a time should then turn each **Turbo Station** and vehicle on again, pointing their **Turbo Station** at their vehicle throughout the process.

# LABEL AND CARD APPLICATION

Please stick the labels to the play set and insert the track card to the play set securely as indicated on the following pages:

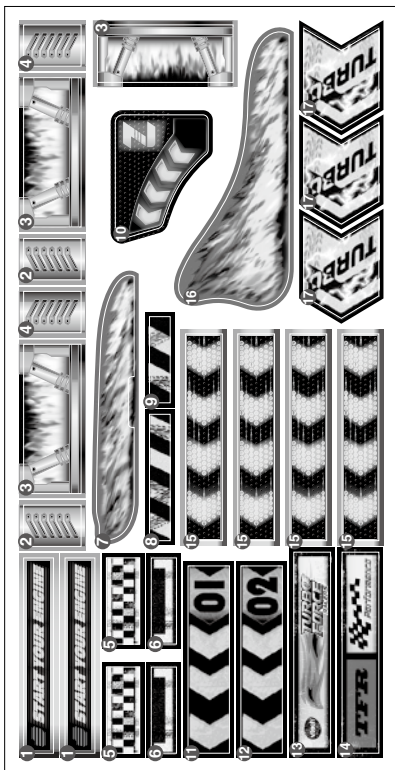

18

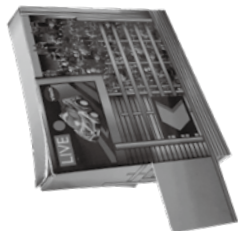
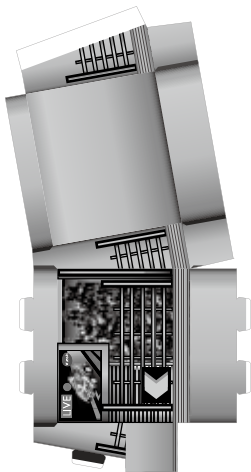

19



20

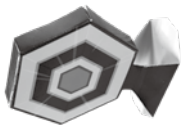
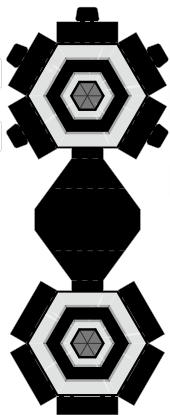

21



22



22



# ASSEMBLY INSTRUCTIONS

With the VTech® Turbo Force® Racers Race Track safety comes first. To ensure your child's safety, adult assembly is required.

1. First, insert the **SPIRAL BRACKETS** into the **SPIRAL BRACKET BASES** to make three rail brackets.

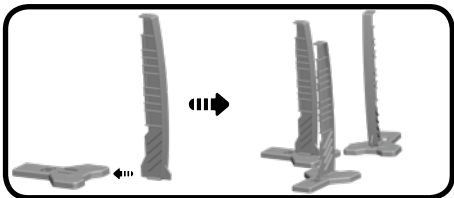

2. Adjust to the appropriate height, insert the **SPIRAL TRACK** into the 3 **SPIRAL BRACKETS** step 1, 2 and 3 shown below and **TWO ROUND TRACKS SINGLE STANDARD** into the 3 **SPIRAL BRACKETS** according to steps 4, 5 and 6 below.

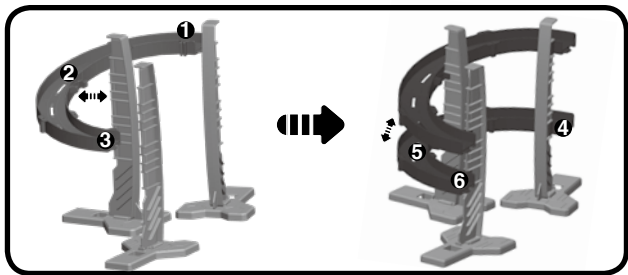



3. As shown, assemble the other **TRACK** accessories to make a complete track.

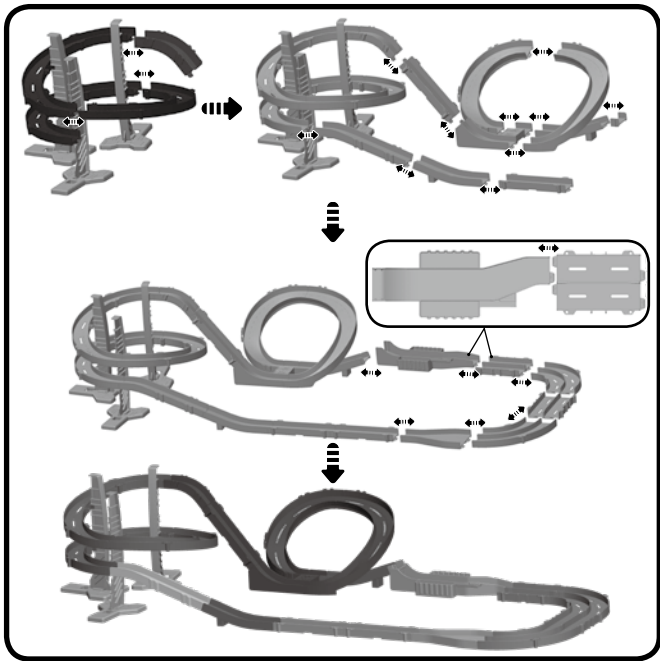

4. After assembling the complete track, you need to insert the **STUNT TRACK HOLDER** under the **STUNT A TRACK** to ensure it is stable. Then place the **DOUBLE GATE** and **SINGLE GATE** on the track as shown.

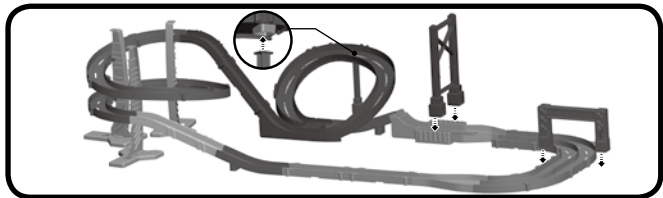

5. Put the **JUMP DOWN TRACK** in the middle of the bridge to form a jump platform. Then insert **TRANSPARENT COVER A**, **TRANSPARENT COVER B** and **TRANSPARENT COVER C** into the buckle on both sides of the track to avoid the car falling off the track.

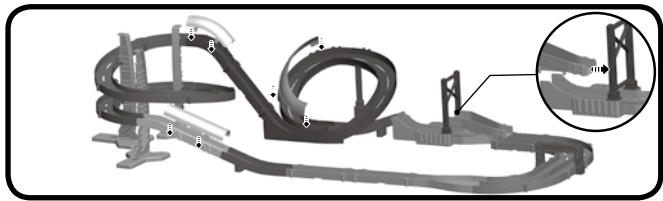

6. Finished! You're ready to go!



There are 4 different track configurations, the instructions are only for one. For more fun try the different configurations below.

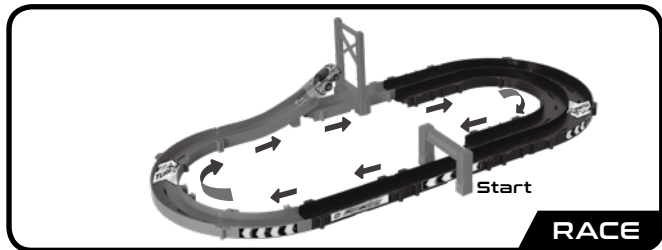
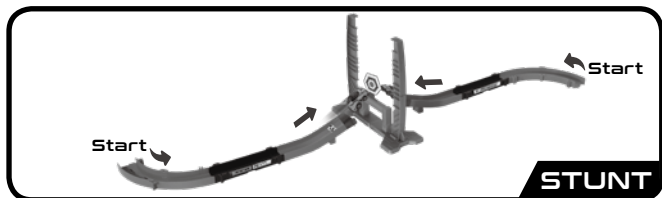
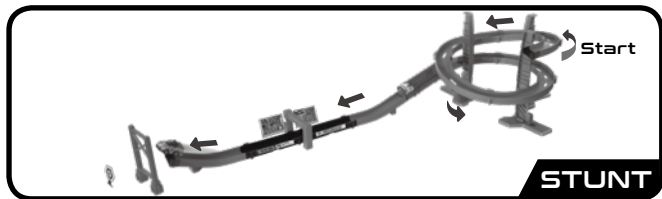

# PRODUCT FEATURES

## TURBO STATION:

### 1. DIRECTIONAL BUTTONS

Touch one of the 6 **Directional Buttons** on the touch panel to control the vehicle and move it in different directions.



### 2. MOTION SENSOR

Shake the **Turbo Station** continuously to charge the turbo speed boost of the vehicle. When you hear the fully charged sound effect, your vehicle is ready to go! You can now press the **Turbo Button** to see your vehicle zoom!



### 3. TALK (OFF) BUTTON

Press the **Talk (OFF) Button** to hear cool conversations between the controller and the vehicle. Holding the **Talk (OFF) Button** for around 2 seconds will also turn the **Turbo Station** off.



#### 4. SOUNDS BUTTON

Press the **Sounds Button** to hear great music and sounds. The vehicle will react to the music and sounds.

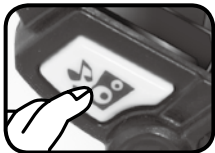

#### 5. TURBO BUTTON *TURBO*

Press the **Turbo Button** to activate the turbo speed boost or to change between turbo and normal speed mode.



#### 6. AUTOMATIC SHUT-OFF

To preserve battery life, the **Turbo Station** will automatically shut off after several minutes without input. The **Turbo Station** can be turned on again by pressing the **Talk**, **Sounds** or **Turbo Button**. If the **Turbo Station** repeatedly shuts off or has abnormal responses, please insert new batteries and try again.

## VEHICLE:

### 1. ON/OFF SWITCH

Slide the switch on the bottom of the vehicle from the **OFF** (●) position to the **ON** (☰) position to turn it on. Slide the switch from the **ON** (☰) position to the **OFF** (●) position to turn it off.

**Note:** We recommend turning off the vehicle to save power when the vehicle is not being played with.

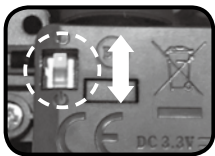

### 2. LIGHTS

The lights on the vehicle will flash with the voices, music and sounds.



# ACTIVITIES

## 1. DRIVING

Touch the **Directional Buttons** to control your vehicle on the Race Track. Shake the **Turbo Station** wristband continuously to charge the turbo speed boost. Once you hear the fully charged sound effect, you can press the **Turbo Button** to see your vehicle zoom!

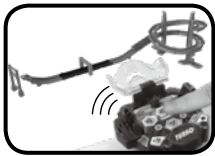

### Note:

1. If your vehicle is not moving in a straight line, you can use the **Alignment Adjust** to straighten the wheels.
2. If your vehicle is not moving smoothly after several rounds of racing, trying giving it a turbo speed boost, or insert it into the **Turbo Station** to fully charge it again.

### Tip:

If you are using the **Turbo Station** without the wristband done up, please ensure nothing is blocking the **IR Controller Sensor**. Please also point the **IR Controller Sensor** at your vehicle whenever possible.

## 2. DOCKED AND CHARGING

Dock your vehicle inside the **Turbo Station** wristband to charge it. Close the lid to secure the vehicle inside. When your vehicle is fully charged, press the **Sounds Button** and the **Talk (OFF) Button** for music, sounds and fun phrases.



# TROUBLESHOOTING

Problem	Solution
The vehicle does not work.	<ol style="list-style-type: none"><li>1. Turn off the vehicle.</li><li>2. Interrupt the power supply by removing the batteries from the controller.</li><li>3. Let the controller stand for a few minutes, then replace the batteries.</li><li>4. Dock your vehicle inside the controller to charge it. Do not hesitate to charge the vehicle several times to ensure it has a full charge.</li><li>5. Turn the vehicle and controller on. Then, point the controller towards the vehicle to play.</li></ol>
The vehicle does not respond to the controller.	
The vehicle stops working suddenly.	
The vehicle lights do not turn on.	
The vehicle lights up, but does not work.	
The controller makes sounds, but the vehicle does not react.	
<b>Turbo mode:</b> Nothing happens when I shake the controller.	Turn the vehicle and controller off and on again. Then, point the controller towards the vehicle and shake the controller to charge the Turbo.

**Tip:** If you are using the **Turbo Station** without the wristband done up, please ensure nothing is blocking the **IR Controller Sensor**. Please also point the **IR Controller Sensor** at your vehicle whenever possible.



## CARE & MAINTENANCE

1. Keep the unit clean by wiping it with a slightly damp cloth.
2. Keep the unit out of direct sunlight and away from any direct heat source.
3. Remove the batteries when the unit will not be in use for an extended period of time.
4. Do not drop the unit on hard surfaces and do not expose the unit to moisture or water.

## TROUBLESHOOTING

If for some reason the program/activity stops working or malfunctions, please follow these steps:

1. Please turn the unit **OFF**.
2. Interrupt the power supply by removing the batteries.
3. Let the unit stand for a few minutes, then replace the batteries.
4. Turn the unit **ON**. The unit should now be ready to play with again.
5. If the product still does not work, install a brand new set of batteries.

If the problem persists, please contact our Consumer Services Department and a service representative will be happy to help you.



# CONSUMER SERVICES

Creating and developing **VTech**<sup>®</sup> products is accompanied by a responsibility that we at **VTech**<sup>®</sup> take very seriously. We make every effort to ensure the accuracy of the information, which forms the value of our products. However, errors sometimes can occur. It is important for you to know that we stand behind our products and encourage you to call our Consumer Services Department with any problems and/or suggestions that you might have. A service representative will be happy to help you.

## **UK Customers:**

Phone: 0330 678 0149 (from UK) or +44 330 678 0149 (outside UK)

Website: [www.vtech.co.uk/support](http://www.vtech.co.uk/support)

## **Australian Customers:**

Phone: 1800 862 155

Website: [support.vtech.com.au](http://support.vtech.com.au)

## **NZ Customers:**

Phone: 0800 400 785

Website: [support.vtech.com.au](http://support.vtech.com.au)

# Product Warranty/ Consumer Guarantees

## **UK Customers:**

Read our complete warranty policy online at [vtech.co.uk/warranty](http://vtech.co.uk/warranty).

## **Australian Customers:**

VTECH ELECTRONICS (AUSTRALIA) PTY LIMITED –  
CONSUMER GUARANTEES

Under the Australian Consumer Law, a number of consumer guarantees apply to goods and services supplied by VTech Electronics (Australia) Pty Limited. Please refer to [vtech.com.au/consumerguarantees](http://vtech.com.au/consumerguarantees) for further information.

**Visit our website for more  
information about our products,  
downloads, resources and more.**

***www.vtech.co.uk***  
***www.vtech.com.au***

